

CABLE TIE & WIRE ACCESSORIES

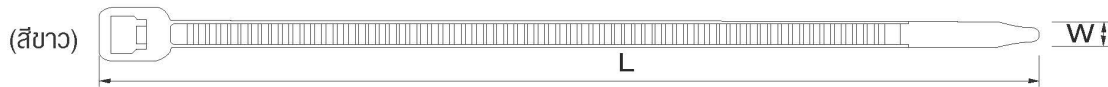

เคเบิลไทร์

CABLE TIES



Item No.	Length (L)		Width	Max.Bundle Dia	Min. Loop Tensile Strength	Packing		Price	
	mm	inch				pcs/bag	pcs/CTN	Baht/pcs	Baht/bag
Nature Color									
PT-100-2C	100	4"	2.5	∅22 (0.87)	8.1 (18)	100	55,000	0.16	16.-
PT-150-3C	150	6"	3.6	∅35 (1.38)	18.2 (40)	100	30,000	0.45	45.-
PT-200-3C	200	8"	3.6	∅53 (20.9)	18.2 (40)	100	20,000	0.62	62.-
PT-200-4C	200	8"	4.8	∅50 (1.97)	22.2 (50)	100	16,000	0.72	72.-
PT-250-4C	250	10"	4.8	∅60 (2.36)	22.2 (50)	100	12,000	1.32	132.-
PT-300-4C	300	12"	4.8	∅76 (2.99)	22.2 (50)	100	11,000	1.48	148.-
PT-370-4C	370	15"	4.8	∅102 (4.02)	22.2 (50)	100	9,000	2.50	250.-



Item No.	Length (L)		Width	Max.Bundle Dia	Min. Loop Tensile Strength	Packing		Price	
	mm	inch				pcs/bag	pcs/CTN	Baht/pcs	Baht/bag
Black Color									
PT-100-2B	100	4"	2.5	∅22 (0.87)	8.1 (18)	100	55,000	0.17	17.-
PT-150-3B	150	6"	3.6	∅35 (1.38)	18.2 (40)	100	30,000	0.48	48.-
PT-200-3B	200	8"	3.6	∅53 (20.9)	18.2 (40)	100	20,000	0.66	66.-
PT-250-4B	250	10"	4.8	∅60 (2.36)	22.2 (50)	100	12,000	1.36	136.-
PT-300-4B	300	12"	4.8	∅76 (2.99)	22.2 (50)	100	11,000	1.52	152.-

แป้นเกาะ

SELFADHESIVE CABLE TIE MOUNTS

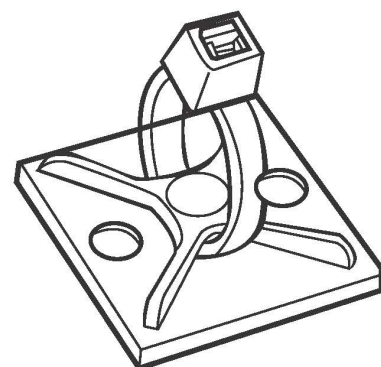
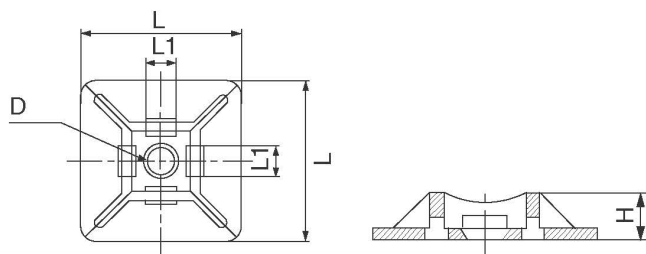

Item No.	L	H	L1	D	Apply to Cable Tie	Packing		Price	
	mm	mm	mm	mm		pcs/bag	Baht/pcs	Baht/bag	
PT-W-2A	12.7	3.2	3.2	--	"M" ties	100	2.4	240.-	
PT-W-3A	19.0	4.41	4.0	∅3.5	"M", "I" ties	100	2.6	260.-	
PT-W-4A	27.7	5.7	5.3	∅5.7	"M", "I", "ST" ties	100	3.75	375.-	

สายรัดอเนกประสงค์ MARKER TIES

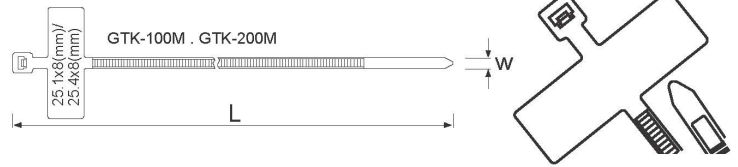

Item No.	Length (L)		Width	Max.Bundle Dia	Min. Loop Tensile Strength	Packing	Price	
	mm	inch	mm	mm	kg (lbs)		pcs/bag	Baht/pcs
PTK-100	112	4.39"	2.5	Ø18	8.1 (18)	100	1.40	140.-
PTK-200	200	7.87"	2.5	Ø50	8.1 (18)	100	2.00	200.-

ตัวล็อกบิด TWIST LOCKS

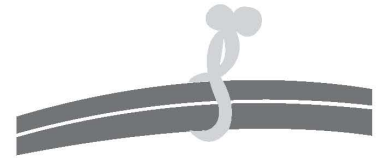
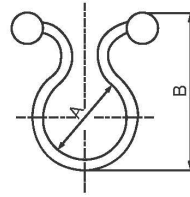

Item No.	A	B	Bundle Dia.	Packing	Price	
	mm	mm	mm		pcs/bag	Baht/pcs
PTL-11	11.50	30.90	~10.5	100	1.10	110.-
PTL-15	15.00	35.10	~14.0	100	1.45	145.-
PTL-19	19.50	42.50	~19.0	100	1.65	165.-

เคเบิลแคลมป์ CABLE CLAMPS

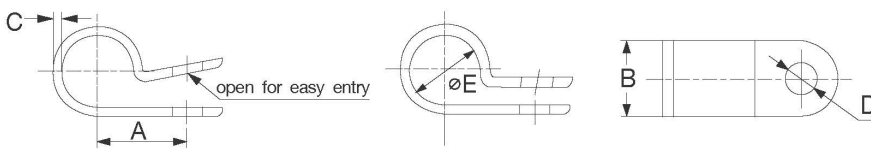
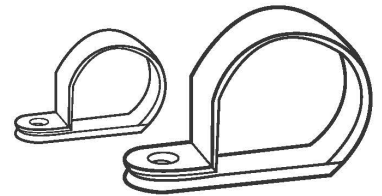

Item No.	ØE	A	B	C	Screw Dia (D)	Packing	Price	
	mm	mm	mm	mm	mm		pcs/bag	Baht/pcs
PTCC-03	3.3	8.2	9.1	1.27	Ø 5.45 for M5	100	1.35	135.-
PTCC-05	4.8	9.6	9.1	1.27	Ø 5.45 for M5	100	1.48	148.-
PTCC-06	6.6	10.3	9.1	1.27	Ø 5.45 for M5	100	1.48	148.-
PTCC-08	7.8	10.6	9.1	1.27	Ø 5.45 for M5	100	1.80	180.-
PTCC-10	9.7	11.9	9.2	1.27	Ø 5.45 for M5	100	1.70	170.-
PTCC-13	12.2	15.0	12.7	1.50	Ø 5.3 for M5	100	4.50	450.-
PTCC-16	13.8	15.8	12.7	1.50	Ø 5.3 for M5	100	4.42	442.-
PTCC-19	18.6	19.8	12.7	1.50	Ø 5.3 for M5	100	4.82	482.-
PTCC-28	27.9	24.6	12.7	1.50	Ø 5.3 for M5	100	6.30	630.-

เป็นสกรูยึดเคเบิลไทร์

SADDLE TIE MOUNTS

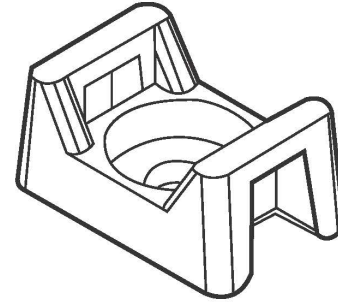
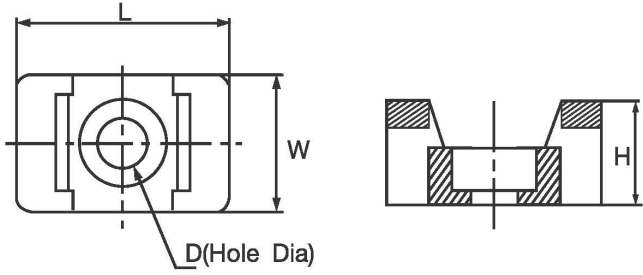

Item No.	L	W	H	D	Apply to Cable Ties	Packing	Price	
	mm	mm	mm	mm		pcs/bag	Baht/pcs	Baht/bag
PTM-2S6	14.9	9.5	7.2	∅3.7	"ST" ties	100	1.15	115.-
PTM-3S10	21.9	15.9	9.7	∅5.0	"HD" ties	100	1.60	160.-

ไส้กั้น

WRAPPING BRAND

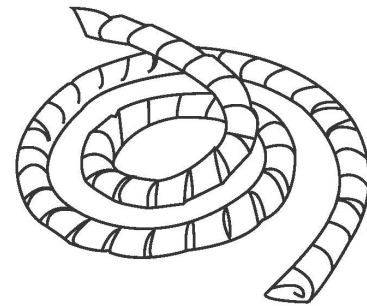
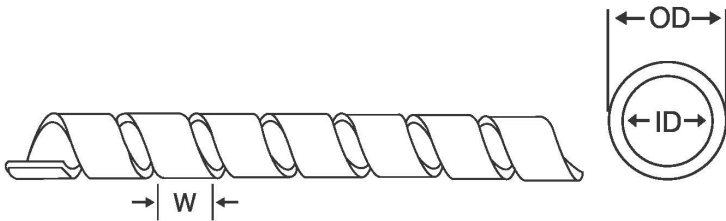



Item No.	In-Diameter	Out-Diameter	W	Wrapping Range	Packing	Price
	mm	mm	mm	mm	M/bag	Baht/bag
PST-06	∅5.0	∅6	7.0	4 - 50	10M	60
PST-08	∅7.0	∅8	10.8	6 - 60	10M	75
PST-10	∅8.5	∅10	11.4	7.5 - 60	10M	80
PST-12	∅10.2	∅12	13.9	9 - 65	10M	90
PST-15	∅13.0	∅15	15.0	12 - 70	10M	120
PST-19	∅16.4	∅19	18.2	15 - 100	10M	180
PST-24	∅21.0	∅24	19.6	20 - 130	10M	240

CATALOG

บริษัท สากล อินเตอร์เทรด (1991) จำกัด
SAKOL INTERTRADE (1991) Co., Ltd.

1296/97-99 ถนนกรุงเทพ-นนทบุรี แขวงบางซื่อ เขตบางซื่อ กรุงเทพฯ 10800

Tel: 02-911-2970-8 Fax: 02-911-2969, 02-587-4097

 www.facebook.com/sakolgroup  www.sakolgroup.com