



Specification

Lightning Protection

AIR TERMINAL (4 PIN)



Application : Provide for use with Air terminal rod 5/8" or conduit size 1/2", 3/4"

Material : High purity copper
 Finished : Blasting

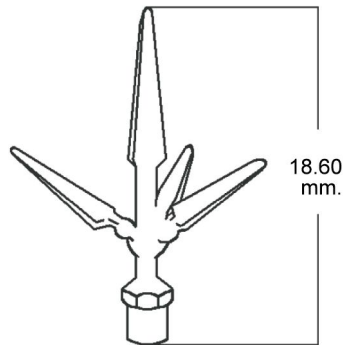

Cat.,No.	Use with		Weight (g.)
	Rod	Conduit	
AT31	-	1/2"	366
AT32	5/8"	-	397
AT33	-	3/4"	444

Lightning Protection

AIR TERMINAL ROD



Application : Firstly work on drawing all point.

Material : Copper rod

Nut : Bronze



Application : Use with Air terminal 4 pin.

Material : Copper rod

Nut : Bronze

Type : Point

Cat.,No.	Dia.	Thread	Lenght (cm.)	Weight (g.)
AA5030	5/8"	5/8"	30	539
AA5050	5/8"	5/8"	50	892
AA5060	5/8"	5/8"	60	1,069
AA5100	5/8"	5/8"	100	1,776
AA5150	5/8"	5/8"	150	2,659
AA5200	5/8"	5/8"	200	3,543
AA5300	5/8"	5/8"	300	5,310
AA6030	3/4"	5/8"	30	715
AA6050	3/4"	5/8"	50	1,220
AA6060	3/4"	5/8"	60	1,472
AA6100	3/4"	5/8"	100	2,480
AA6150	3/4"	5/8"	150	3,742
AA6200	3/4"	5/8"	200	5,000
AA6300	3/4"	5/8"	300	7,500

Type : Thread

Cat.,No.	Dia.	Thread	Lenght (cm.)	Weight (g.)
AB5030	5/8"	5/8"	30	551
AB5050	5/8"	5/8"	50	904
AB5060	5/8"	5/8"	60	1,081
AB5100	5/8"	5/8"	100	1,788
AB5150	5/8"	5/8"	150	2,671
AB5200	5/8"	5/8"	200	3,555
AB5300	5/8"	5/8"	300	5,319
AB6030	3/4"	5/8"	30	706
AB6050	3/4"	5/8"	50	1,210
AB6060	3/4"	5/8"	60	1,463
AB6100	3/4"	5/8"	100	2,472
AB6150	3/4"	5/8"	150	3,734
AB6200	3/4"	5/8"	200	4,995
AB6300	3/4"	5/8"	300	7,500



Specification









Lightning Protection

AIR TERMINAL BASE

Material : High purity copper

Standard Finish : Blasting

Screw & washer : Stainless steel

Cat.,No.	Description	Weight (g.)
AT00	 <p>Provide for wire # 70 , 95 mm² Horizontal flat surfaces location installation , cross bare copper wire support.</p>	946
AT11	 <p>Provide for bus bare 3 x 25 mm Horizontal flat surfaces location installation , cross bare copper bus bare support.</p>	927
AT12	 <p>Provide for bus bare 3 x 25 mm Horizontal flat surfaces location installation , cross bare copper bus bare support.</p>	877
AT18	 <p>Provide for wire # 50 , 70 mm² Bolt Horizontal and vertical flat surfaces location installation , 180 degree adjustable rod erect fasten head , bare coper wire support.</p>	942
AT24	 <p>Provide for wire # 50 , 70 , 95 , 120 mm² Horizontal flat surfaces location installation (rod erect on center) , plus+frame junction bare copper wire support.</p>	812
AT25	 <p>Provide for wire # 35 , 50 , 70 , 95 mm² Horizontal flat surfaces location installation (rod erect on center) , plus+frame junction bare copper wire support.</p>	681
AT51	 <p>Provide for wire # 35 , 50 , 70 mm² Horizontal flat surfaces location installation parallel bare copper wire support (Horizontal or vertical)</p>	568
AT52	 <p>Provide for wire # 35 , 50 , 70 mm² Vertical flat surfaces location installation parallel bare copper wire support (Horizontal or vertical)</p>	572

GROUND TEST BOX

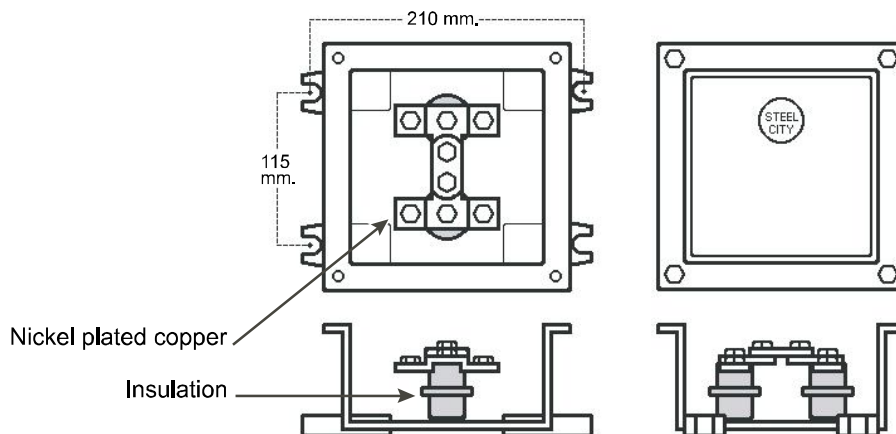
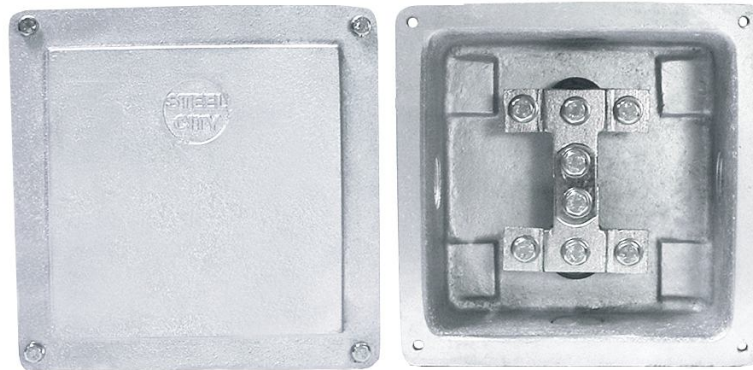

Application : Connection between copper wire and ground rod.
For testing resistance.

Features : Disconnect central busbar while testing resistance,
Connect the busbar after tested.

Size : 20 x 20 x 10 cm.

Material

Body : Die Cast Aluminium
Terminal : Nickel plated copper
Terminal Screw : Stainless 8 mm.
Cover Screw : Stainless 5 mm.

Weight : 3.6 Kg.

Cat.,No. : GRTB



Specification

Lightning Protection

G. B. CLAMP

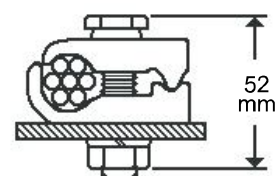
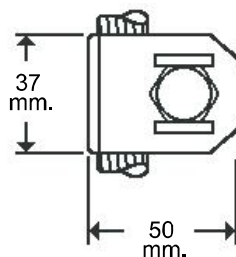
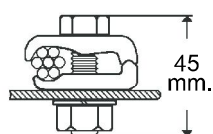
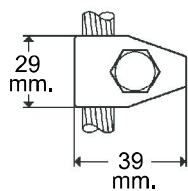

Cat.,No. GRB1

Cat.,No. GRB1

Application : For clamping ground lead cable to support flat metal surface. Requires only wrench for installation.

Material : High Purity Copper

Screw : Stainless

Cat.,No.	For Cable (mm ²)	Screw	Weight (g.)
GRB1	25~70	M10x30	133
GRB2	70~120	M12x40	250

Wire Fitting

U CLAMP 2 SCREWS

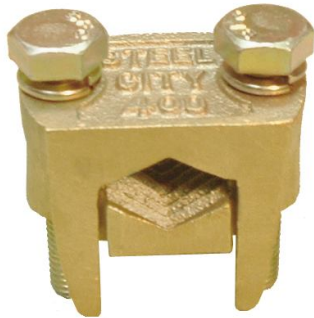

Application : Connection copper conductor.
Main & Main, or Main & Tap.

Features : Fasten bolt with wrench.

Material : Brass

Bolt : Steel bolt / Spring washer.

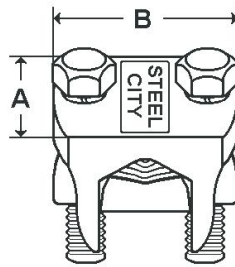

Cat.,No.	For Cable (mm ²)	Dimension (mm.)		Bolt Size	Weight (g.)
		A	B		
UC81	6~35	20	31	ø 1/4" x 1"	69
UC82	50~70	25	34	ø 1/4" x 1-1/4"	100
UC83	95~120	28	42	ø 5/16" x 1-1/2"	173
UC84	150~185	33	51	ø 3/8" x 2"	290
UC85	240~300	35	58	ø 7/16" x 2"	390
UC86	400	38	62	ø 7/16" x 2-1/2"	476
UC87	500	40	65	ø 7/16" x 2-1/2"	561



Specification

Wire Fitting

TERMINAL LUG



Cat.,No. TL81 ~ TL82



Cat.,No. TL83 ~ TL85



Cat.,No. TL86 ~ TL87

Application : Terminate end of conductor to pole of switch, load center.

Material : High purity copper

Finished : Blasting

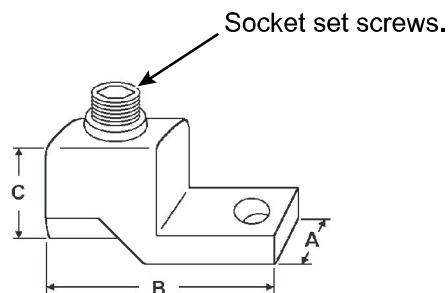

Cat.,No.	For Cable (mm ²)	Dimension (mm.)			Weight (g.)
		A	B	C	
TL81	6~35	16	33	23	49
TL82	50~70	16	34	24	56
TL83	95~120	23	60	27	129
TL84	150~185	28	69	34	224
TL85	240~300	33	78	41	338
TL86	400	38	115	47	528
TL87	500	40	125	50	628



Grounding Fitting

GROUND ROD COPPER ELECTROLYED TYPE



Application : Connection electrical appliance body with ground conductor to the end of ground rod.

Material : Steel Shaft

Finished : Copper Electrolyed

Cat.,No.	Dia.	Length (cm.)	Weight (g.)
GR01	1/2"	180	1,780
GR02	1/2"	240	2,400
GR03	1/2"	300	3,000
GR11	5/8"	180	2,810
GR12	5/8"	240	3,740
GR13	5/8"	300	4,670



Specification

Grounding Fitting

GROUND ROD SECTIONAL TYPE (THEADED 2 END)



Application : Sectional ground rod are designed to meet the requirements for deep, dependable, low resistance grounds.

Material : Steel Shaft

Finished : Copper Electrolyed

Cat.,No.	Dia.	Length (cm.)	Weight (g.)
GR21	5/8"	180	2,800
GR22	5/8"	240	3,700
GR23	5/8"	300	4,600

GROUND ROD COUPLING



Application : For couple sectional type ground rod.

Material : Brass

Finished : Copper Electrolyed.

Weight : 110 g.

Cat.,No. : GRP71



Specification

Grounding Fitting

GROUND ROD COPPER CLAD TYPE



Application : Use for lightning protection system.

Features : Drive ground rod down at earth,
welding lightning conductor at the
end of ground rod.

Material : Steel Shaft

Finished : Copper Clad

Cat.,No.	Dia.	Length (cm.)	Weight (g.)
GR51	5/8"	180	2,600
GR52	5/8"	240	3,500
GR53	5/8"	300	4,300
GR61	3/4"	180	3,660
GR62	3/4"	240	4,880
GR63	3/4"	300	6,100



HDG. Grounding Fitting

GROUND ROD HOT DIP GALVANIZED TYPE



Application : Connection electrical appliance body with ground conductor to the end of ground rod.

Material : Steel shaft

Standard Finish : Hot Dip galvanized

Cat.,No.	Dia.	Length (cm.)	Weight (g.)
HGR11	5/8"	180	2,800
HGR12	5/8"	240	3,800
HGR13	5/8"	300	4,700



Specification

Grounding Fitting

ELLIPSE GROUND CLAMP



Application : Ellipse ground clamp affords quick and easy connection of ground wires to ground rod. Only one piece to handle, it is a complete unit assembly thus preventing possible loss of part.

Material : Brass

Finished : Blasting

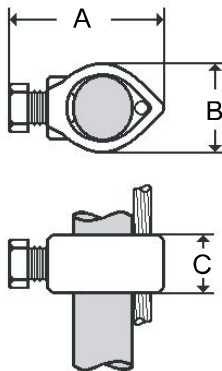

Cat.,No.	Dia.	Conductor (cm.)		Dimension (cm.)			Weight (g.)
		A	B	A	B	C	
GR71	5/8"	3	5	38	29	17	42
GR72	3/4"	3	5	45	27	17	62

COPPER GROUND CLAMP



Application : Copper ground clamp is used for connecting the ground bus, either parallel to, or at right angles to rod or pipe. Easily installed, the connection is completed by merely tightening

Features : The connection is completed by merely tightening the two nuts on the U-bolt, nuts and lockwashers, permit entire connection to be buried in the ground without danger of corrosion

Material : High Purity Copper , Stainless Shaft

Finish : Blasting

Weight : 400 g.

Cat.,No. : GR73

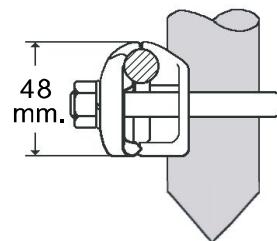
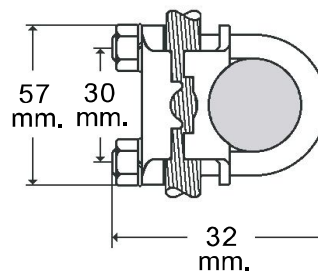
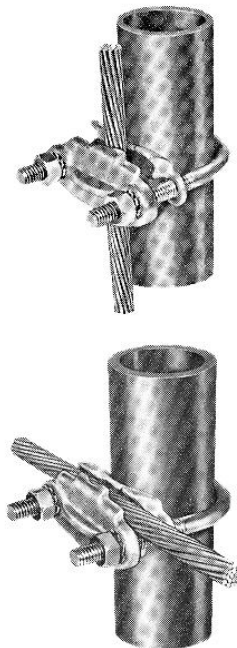



3 GROOVE GROUND CLAMP

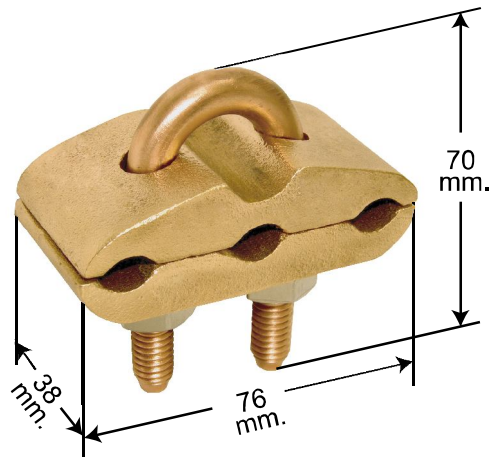

Application : Ground clamp for three conductor is used for connecting the ground bus, either parallel to, or at right angles to rod or pipe.
Easily installed, the connection is completed by merely tightening

Features : The connection is completed by merely tightening the two nuts on the U-bolt, nuts and lockwashers, permit entire connection to be buried in the ground without danger of corrosion

Material :

- Body : Casting Copper Alloy
- Bolt&Nut : Bronze

Finish : Blasting

Weight : 520 g.

Cat.,No. : GR74

SADDLE WALL CLAMP



Application : For snap bare copper wire
install on wall, ceiling.

Material : High Purity Copper

Finished : Blasting

Screw : Stainless M6 x 15

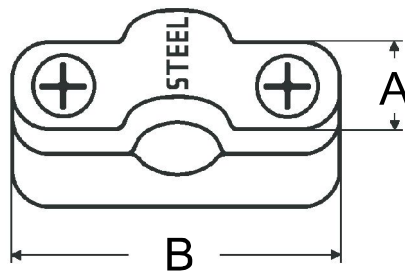

Cat.,No.	For Cable (mm ²)	Dimension (cm.)		Weight (g.)
		A	B	
GR81	25~35	16	55	85
GR82	50~70	18	52	108
GR83	95~120	16	57	100



Specification

Grounding Fitting

CROSS CABLE SQUARE CLAMP



Application : For snap double bare copper wire
25, 35 , 50 mm² cross junction.

Size : 2" x 2" x 1¹/₈"

Material : High Purity Copper

Finished : Blasting

Screw : Stainless M6 x 15

Weight : 314 g.

Cat.,No. : GR85

ROUND BASE TOWER SADDLE CLAMP



Application : For snap 50, 70, 95 mm² bare copper wire install on wall, ceiling.

Material : High Purity Copper

Finished : Blasting

Screw : Stainless M6 x 20

Spring Washer : Stainless

Weight : 557 g.

Cat.,No. : GR84

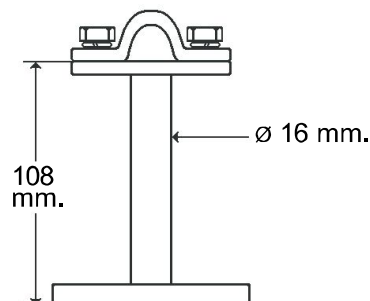
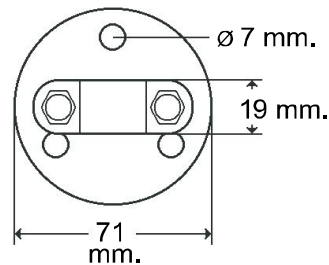



Specification

Grounding Fitting

T CLAMP



Application : For snap double bare copper wire 25, 35, 50 mm² T-junction.

Material : High Purity Copper

Finish : Blasting

Screw : Stainless M8 x 30

Washer & Spring : Stainless

Weight : 134 g.

Cat.,No. : GR86

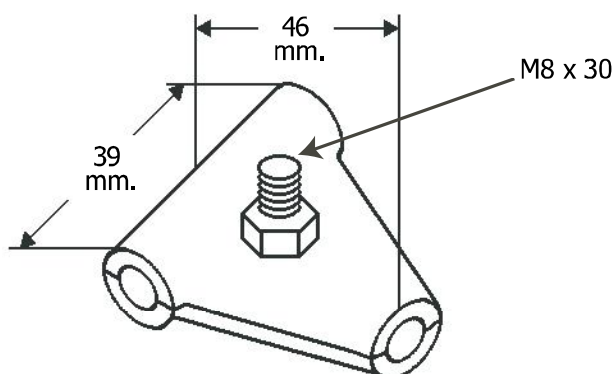

NICKEL PLATED COPPER SPLIT-BOLT



Application : Connection various size copper conductor, Main & Main, Main & Tap.

Features : Nickel plated for increase conduction electrical current.

Material : Copper alloy

Finish : Nickel plated

Cat.,No.	Size		For Cable (mm ²)	Weight (g.)
	A.W.G.	mm ²		
SP010	8	10	10	12
SP016	6	16	16	22
SP025	4	25	25	29
SP035	2	35	35	40
SP050	1/0	50	50	56
SP070	2/0	70	70	92
SP120	250	120	120	167
SP185	350	185	185	307
SP240	500	240	240	422



BUS BARE CLAMP



Application : For snap bus bare 3 x 25 mm.
Install on wall, ceiling.

Size : 19 x 55 mm.

Material : High Purity Copper

Finished : Blasting

Screw : Stainless M6 x 15

Weight : 96 g.

Cat.,No. : GR91

CROSS BUS BARE CLAMP



Application : For snap double 3 x 25 mm.
copper busbare.
Cross junction.

Size : 57 x 57 x 16 mm.

Material : High Purity Copper

Finished : Blasting

Screw : Stainless M6 x15

Weight : 313 g.

Cat.,No. : GR92



Specification

Wire Fitting

CONNECTOR DEAD END



Application : For keep the end of single aluminium conductor safety.

Features : Strong, Unbroken.

Material : Aluminium alloy

Screw : Steel bolt

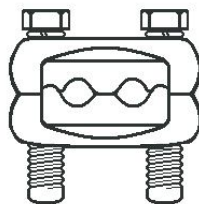
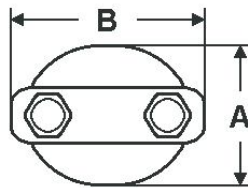

Cat.,No.	For Cable (mm ²)	Dimension (mm.)		Screw Size	Weight (g.)
		A	B		
PG01	25~35	45	46	5/16" x 1-1/4"	105
PG02	50~70	60	60	3/8" x 1-1/2"	190
PG03	95~120	69	68	3/8" x 2"	275

Wire Fitting

PARALLEL GROOVE CLAMP



Cat.,No. : PG10



Cat.,No. : PG11



Cat.,No. : PG12~PG13

Application : Connection various size aluminium conductor in the parallel groove, Main & Main, Main & Tap.

Features : Strong, Unbroken.

Material : Aluminium alloy

Screw : Steel bolt

Cat.,No.	For Cable (mm ²)	Dimension (mm.)		Screw Size	Weight (g.)
		A	B		
PG10	10	20	28	M6 x 20	15
PG11	16~50	37	25	Ø 5/16" x 1-1/4"	44
PG12	16~70	42	49	Ø 5/16" x 1-1/2"	117
PG13	25~95	47	55	Ø 5/16" x 1-3/4"	141



Specification

Wire Fitting

MESH PARALLEL GROOVE CLAMP



Application : Connector various size ACSR conductor in the parallel groove. Main & Main, Main tap 50, 70, 95, 120, 185 mm²

Features : Strong, Unbroken.

Material : Aluminium alloy

Screw : Steel bolt

Weight : 525 g.

Cat.,No. : PG14

